

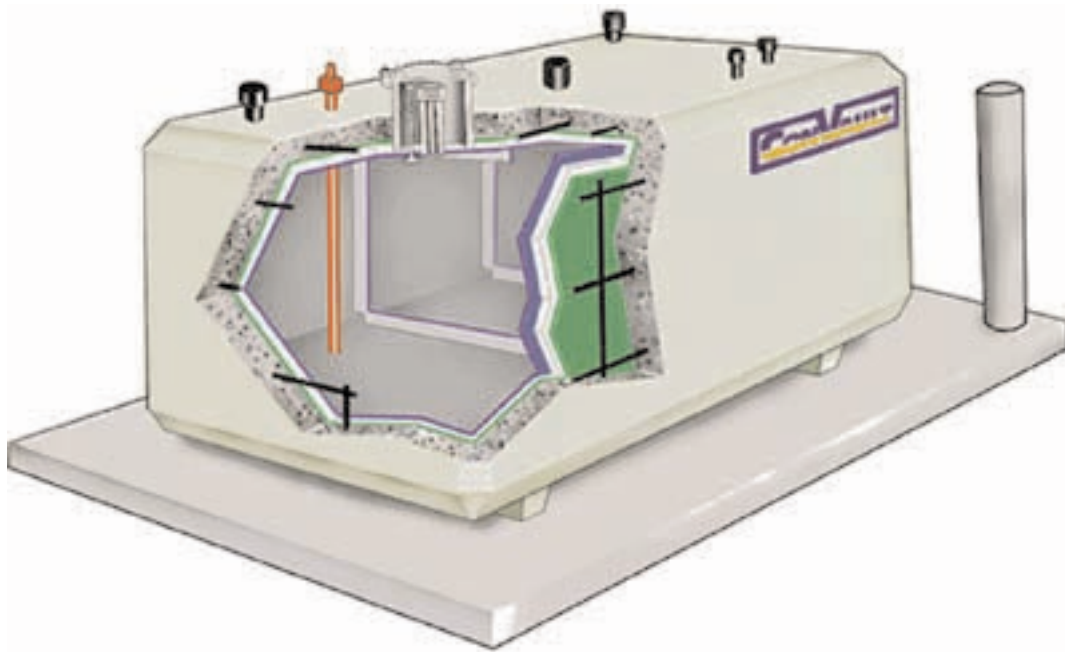

FUEL STORAGE & DISPENSING SYSTEMS



Engineered for Safety

ConVault Protected AST's are engineered to survive in the real world. Utilizing patented manufacturing procedures, the resulting product is a tank for flammable liquids seamlessly encapsulated in six-inch thick concrete with integral secondary containment, thermal stability, vehicle impact protection, and projectile protection. The system contains no cold joints or heat transfer points on the bottom or the sides.

ConVault primary steel tanks (including spill containment basins) are fabricated in accordance with UL 142 (Seventh Edition). Each unit is pressure tested twice at the factory using ConVault patented processes to insure proper performance in the field. ConVault Protected AST's are shop-fabricated under strict quality controls in accordance with UL 2085 and ULC-S655 and ULC-S602 for Protected Tanks. Primary and secondary containment are independently tested at the plant in accordance with UL and ULC requirements.

The ConVault Protected AST is listed in accordance with UL 2085, ULC-S655, and ULC-S602 Insulated/Secondary Containment for Aboveground Storage Tanks, Protected Type. The six-inch thick (6") concrete exterior acts as a thermal mass reducing temperature variations, provides a non-corrosive, durable exterior, and provides protection for the secondary containment. The ConVault Protected AST system has passed numerous performance tests including 2-hour liquid pool and furnace fire tests, vehicle impact test and projectile-resistance test. Numerous real-life events have also proven the safety of the system.

The end result: owners and operators of ConVault Protected AST's are provided with PEACE OF MIND.

US Measurements					Metric Measurements				
ConVault Size Gallons	Weight Pounds	A (Length) ft. & in.	B (Width) ft. & in.	C (Height) ft. & in.	ConVault Size Liters	Weight kg	A (Length) mm	B (Width) mm	C (Height) mm
125	6,200	4' 0.5"	4' 0.5"	3' 11"	1 000	4 000	2 350	1 150	1 100
250	8,000	7' 8"	3' 9.5"	3' 3"	2 000	6 000	3 300	1 450	1 100
500	12,000	11' 0"	4' 6"	3' 4"	4 000	9 000	3 300	1 750	1 450
1,000	18,000	11' 0"	5' 8"	4' 4"	6 000	12 000	3 400	2 400	1 500
2,000	30,000	11' 3"	8' 0"	5' 6"	8 000	13 500	3 400	2 400	1 800
3,000 LP	36,000	11' 3"	8' 0"	7' 3.5"	12 000	18 000	4 900	2 400	1 800
4,000 LP	44,000	17' 7"	8' 0"	6' 5.25"	16 000 LP	22 000	5 800	2 400	1 950
4,000 DW	44,000	12' 2"	8' 0"	8' 9"	16 000 HP	20 000	4 050	2 400	2 650
5,200 HP	47,000	15' 6"	8' 0"	8' 9"	20 000 LP	21 000	7 150	2 400	1 950
6,000 HP	60,000	17' 7"	8' 0"	8' 9.25"	20 000 HP	24 000	4 950	2 400	2 650
8,000 HP	72,000	23' 1"	8' 0"	8' 9.25"	22 000	25 000	5 400	2 400	2 650
10,000 HP	87,000	28' 7"	8' 0"	8' 9.25"	25 000	28 000	6 100	2 400	2 650
12,000 HP	101,000	34' 1"	8' 0"	8' 9.25"	30 000	34 000	7 250	2 400	2 650
					35 000	41 000	9 100	2 400	2 650
					45 000	46 000	10 700	2 400	2 650

Cylindrical			
Size Gallons	Weight Pounds	Diameter ft. & in.	Length ft. & in.
4,000 Cyl	46,000	9' 4.5"	11' 11"
5,200 Cyl	52,000	9' 4.5"	15' 1.5"
6,000 Cyl	60,000	9' 4.5"	17' 3"
8,000 Cyl	72,000	9' 4.5"	22' 7"
10,000 Cyl	80,000*	9' 4.5"	27' 11"
12,000 Cyl	90,000*	9' 4.5"	33' 3"

* If "lightweight Concrete is used."

Most units are also available as a split unit in several configurations.

Caution! All sizes are not available from all manufacturing plants. Shape, dimensions, and weights may vary between manufacturing plants. Other sizes not listed may be available.

Check with your local representative.

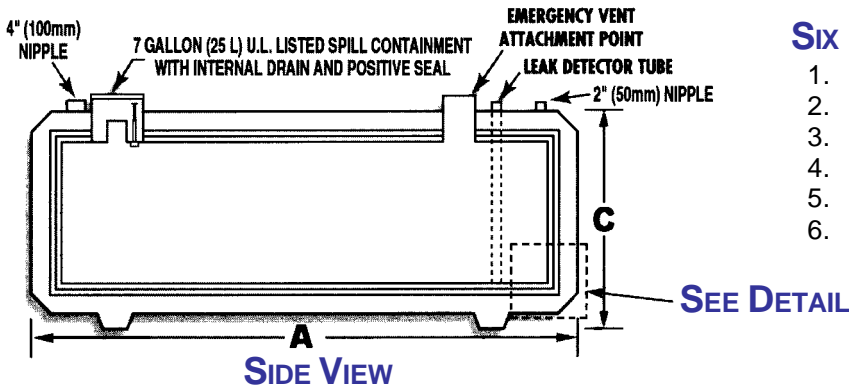

SIX STEP PROCESS

1. Steel Tank
2. 1/4" (6mm) Styrofoam Insulation
3. 30 Mil. (0.76mm) HDPE Liner
4. 1/2" (12mm) Rebar
5. 6" (105mm) Monolithic Concrete
6. Finish

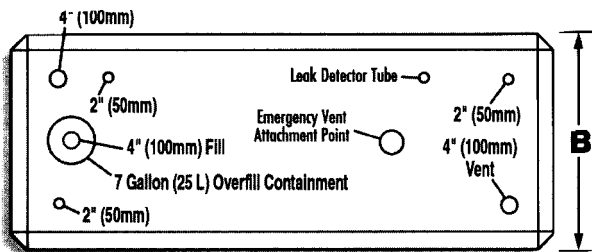
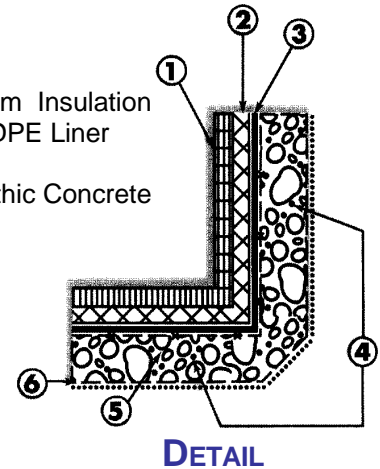

TOP VIEW

U.S. PATENT #4,826,644; #4,931,235;
#4,934,122; #4,963,082; #4,986,436;
#5,064,155; #5,157,888; #5,174,079;
#5,234,191; #5,126,095



(OTHER U.S. & FOREIGN PATENTS PENDING)